

# BRUCKNER COMMONS

LEASING OPPORTUNITIES IN THE BRONX, NY

**Bruckner Commons** is a large open-air regional shopping center located off the Bruckner Expressway (I-287) in the heart of the Bronx, NY. The property is anchored by ShopRite and also includes Aldi, Burlington, Marshalls, Old Navy, Five Below, City MD and Starbucks. The center's size, tenant mix and accessibility, along with ample on-site parking attract shoppers from a larger radius than most urban centers.



**\$5.8 BILLION**  
ANNUAL RETAIL  
SPEND WITHIN A  
3-MILE RADIUS

**\$73,391**  
AVERAGE HOUSEHOLD  
INCOME IN A 5-MILE  
RADIUS

**2.1 MILLION**  
CONSUMERS WITHIN  
A 5-MILE RADIUS

**4.1 MILLION**  
VISITORS TO THE  
CENTER IN 2024

*Data from Placer.ai*

## LEASING CONTACT

Joshua Birns [jbirns@uedge.com](mailto:jbirns@uedge.com) | 201.370.3330

# URBAN EDGE

# LEASING OPPORTUNITIES



COMMON AREA  
VESTIBULE ENTRANCE

## SECOND FLOOR SPACE AVAILABLE, EASILY ACCESSIBLE FROM COMMON AREA VESTIBULE. CLEAR VISIBILITY TO **70,927 VEHICLES** PER DAY ON THE BRUCKNER EXPRESSWAY

Bruckner Commons is located off of the Bruckner Expressway (I-287) in the heart of the Bronx. Within walking distance of this regional center are a variety of community attractions, such as Story Playground and Success Academy Charter School. Bruckner Commons serves the Soundview, Park Chester, Shore Haven, Classon Point, and Castle Hill neighborhoods. The center is easily accessible and transit-friendly. Multiple local and express buses stop at or near the center and the #6 subway is a 15-minute walk away.

**THE PROPERTY IS CURRENTLY UNDERGOING A MULTI-MILLION-DOLLAR REDEVELOPMENT THAT WILL INCLUDE NEW RETAIL BUILDINGS, UPDATED FACADES, NEW WAYFINDING SIGNAGE, AND UPDATES TO THE PARKING LOT AND SIDEWALKS THAT WILL IMPROVE WALKABILITY**

### LEASING CONTACT

Joshua Birns [jbirns@uedge.com](mailto:jbirns@uedge.com) | 201.370.3330

# URBAN EDGE

# LEASING OPPORTUNITIES

## COMMON AREA VESTIBULE

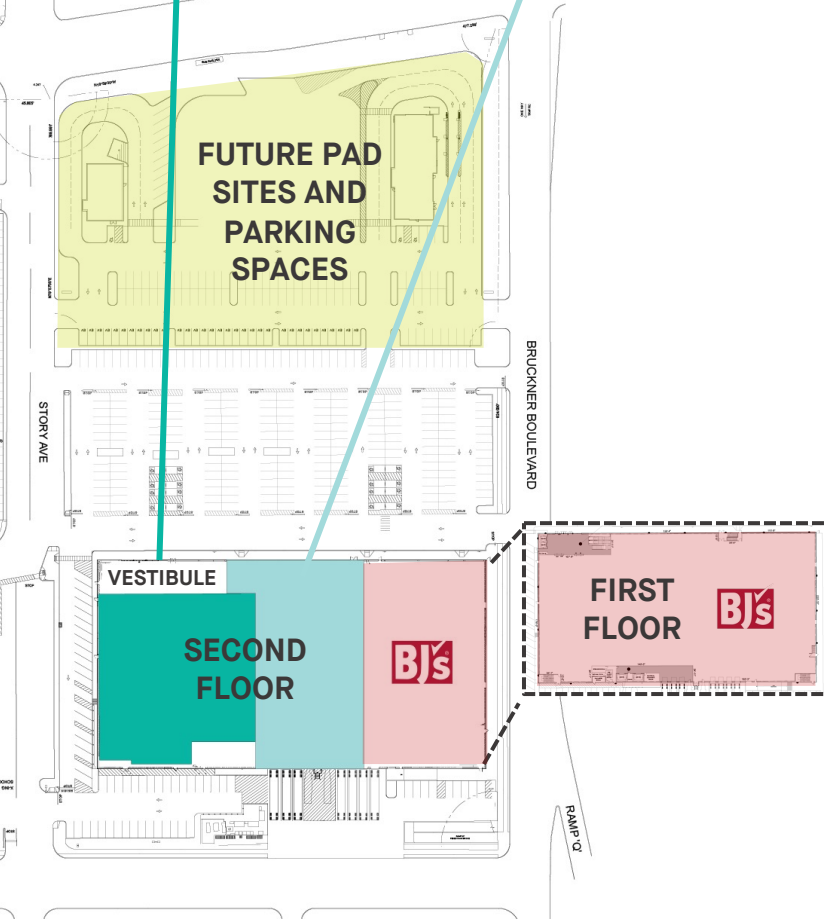
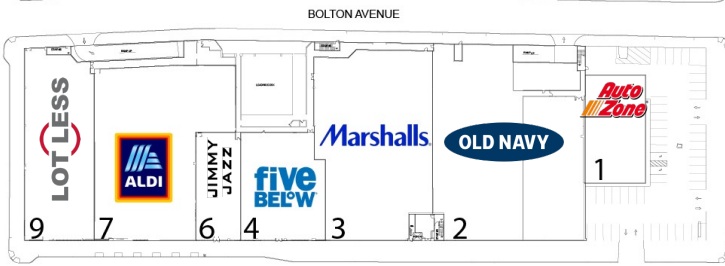
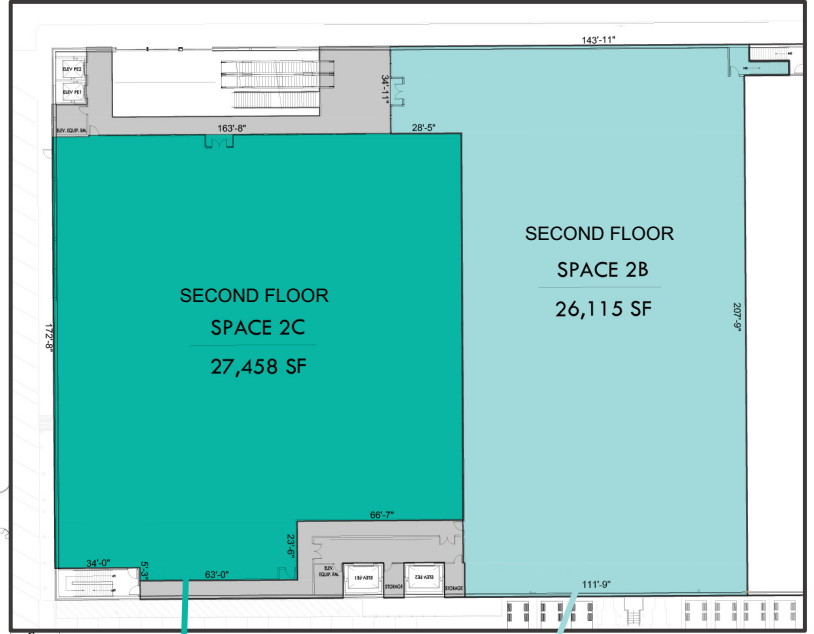

### LEASING CONTACT

Joshua Birns jbirns@uedge.com | 201.370.3330

# URBAN EDGE